

April 13, 2022

ADDENDUM #1

TO CONTRACT DOCUMENTS FOR: Project #CP212202 – Turner Avenue Parking Structure – Various Structure Repairs

ADVERTISEMENT DATE: March 28, 2022

PREPARED FOR: The Curators of the University of Missouri

CONSULTANT: Structural Engineering Associates, Inc.
1000 Walnut Street, Suite 1570
Kansas City, MO 64106
(816) 421-1042

The contract documents for the above noted project and the work covered thereby are herein modified.

GENERAL INFORMATION:

- 1) **Questions and Answers**
 - a. Q) At stair towers where there is a barrier wall next to entrance, should we use the winged expansion joint across walking surface and compression expansion joint along barrier wall?
A) No, use winged expansion joint continuously and at the wall follow manufacturers recommendations for deck to wall connections.

PROJECT MANUAL:

- 1) No Changes.

DRAWINGS:

- 1) Drawing Sheet S107, Parking Structure Second Level Plan: **ADD** Note 3, “Contractor to add a total of 10 accessible parking stalls to be located by Owner’s Representative. Existing striping in these locations to be removed by hand grinding or wire brush.” **Replace sheet in its entirety with attached sheet.**
- 2) Drawing Sheet S108, Parking Structure Third Level Plan: **ADD** Note 3, “Contractor to add a total of 10 accessible parking stalls to be located by Owner’s Representative.

Existing striping in these locations to be removed by hand grinding or wire brush.”

Replace sheet in its entirety with attached sheet.

- 3) Drawing Sheet S109, Parking Structure Roof Level Plan: **ADD** Note 3, “Contractor to add a total of 10 accessible parking stalls to be located by Owner’s Representative. Existing striping in these locations to be removed by hand grinding or wire brush.”
Replace sheet in its entirety with attached sheet.

END OF ADDENDUM #1



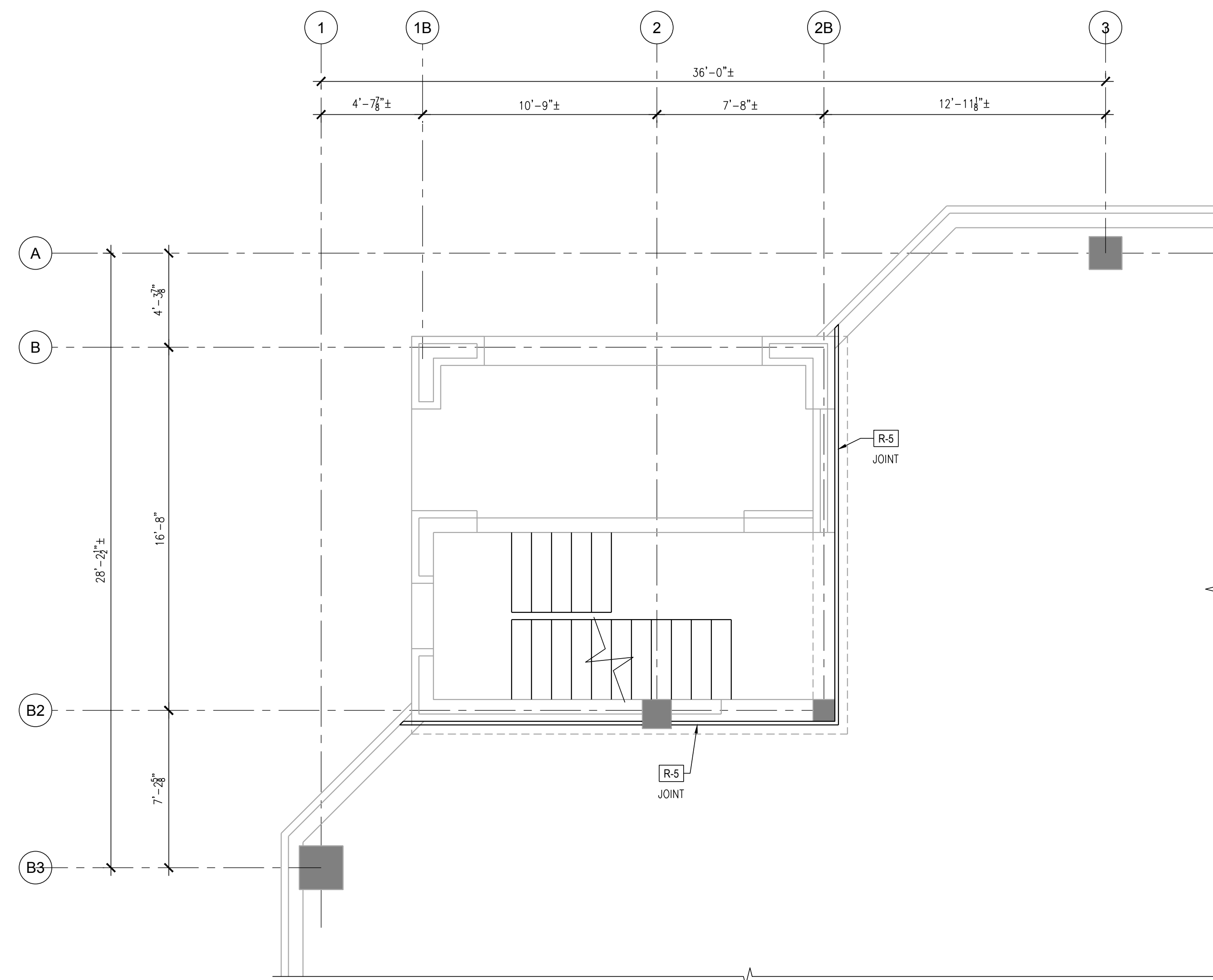

4 STAIR SECOND LEVEL
1/4" = 1'-0" N

NOTE:
CONTRACTOR TO CAPTURE ONE (1) PARKING STALL ON EACH SIDE OF STAIR TOWER AND ONE (1) ADDITIONAL STALL FOR LAY DOWN AREA OR VEHICLE INSIDE FENCED AREA DURING REPAIRS

- NOTE:
- CONTRACTOR SHALL ONLY WORK ON ONE STAIR TOWER AT A TIME
 - CONTRACTOR TO PROVIDE PEDESTRIAN BARRICADE W/ EMERGENCY EGRESS TO ALL LEVELS OF STAIR TOWER UNDER CONSTRUCTION ALONG WITH SIGNAGE INDICATING ACCESS TO STAIR TOWER IS CLOSED (REF: SPECS)
 - CONTRACTOR TO ADD A TOTAL OF TEN (10) ACCESSIBLE PARKING STALLS ON LEVEL ONE, TO BE LOCATED BY OWNERS REPRESENTATIVE. EXISTING STRIPING IN THESE LOCATIONS TO BE REMOVED BY HAND GRINDERS OR WIRE BRUSH.

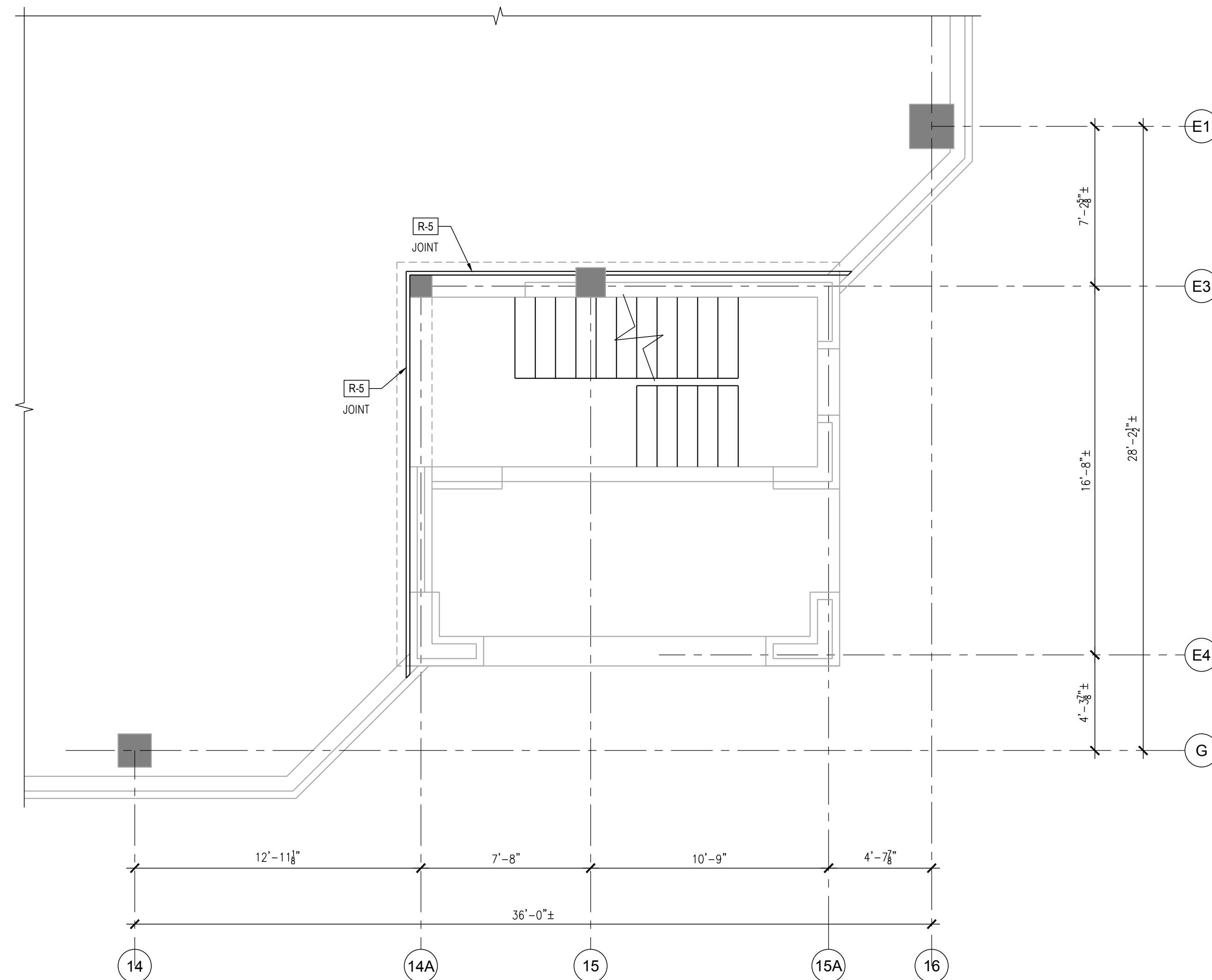

3 STAIR SECOND LEVEL
1/4" = 1'-0" N

NOTE:
CONTRACTOR TO CAPTURE ONE (1) PARKING STALL ON EACH SIDE OF STAIR TOWER AND ONE (1) ADDITIONAL STALL FOR LAY DOWN AREA OR VEHICLE INSIDE FENCED AREA DURING REPAIRS

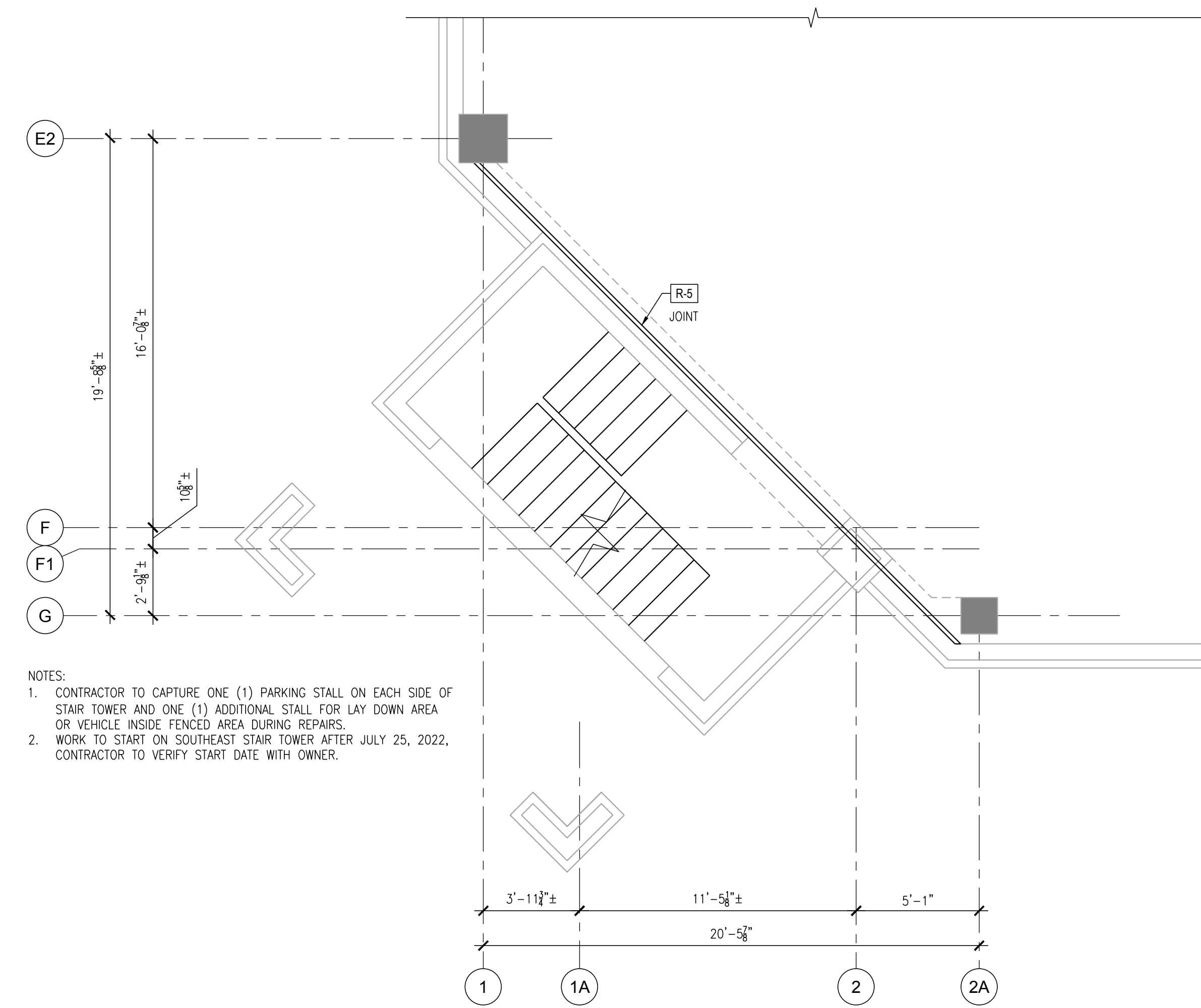

2 STAIR SECOND LEVEL
1/4" = 1'-0" N

- NOTES:
- CONTRACTOR TO CAPTURE ONE (1) PARKING STALL ON EACH SIDE OF STAIR TOWER AND ONE (1) ADDITIONAL STALL FOR LAY DOWN AREA OR VEHICLE INSIDE FENCED AREA DURING REPAIRS.
 - WORK TO START ON SOUTHEAST STAIR TOWER AFTER JULY 25, 2022. CONTRACTOR TO VERIFY START DATE WITH OWNER.

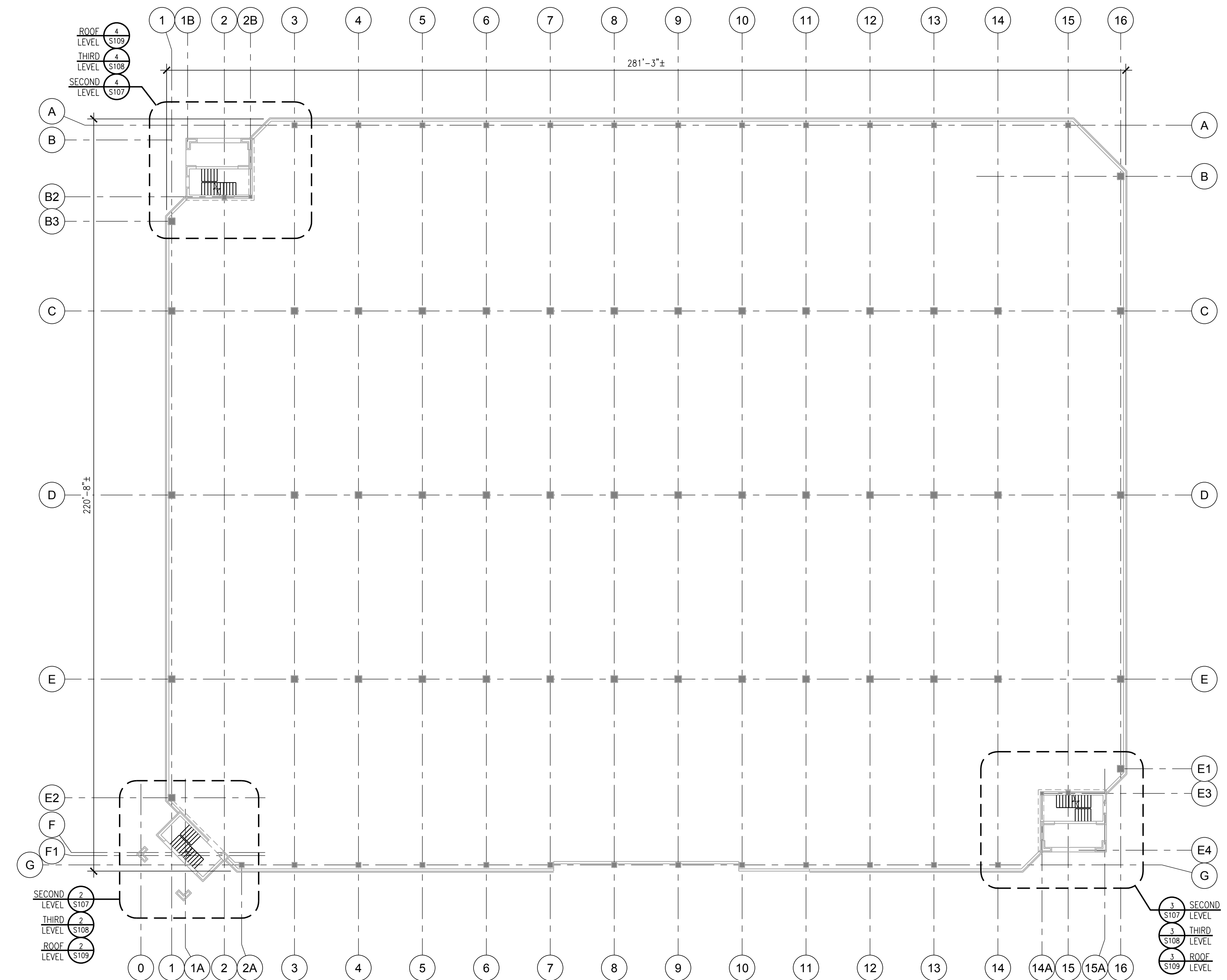

1 EXISTING CONLEY AVENUE PARKING STRUCTURE - SECOND LEVEL PLAN
3/32" = 1'-0" N

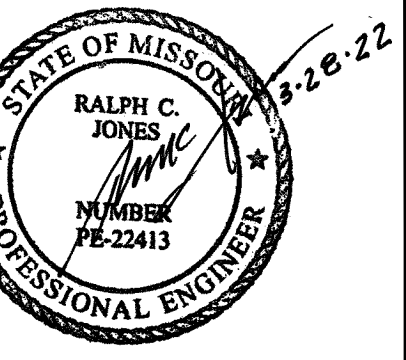

RALPH C. JONES
Professional Engineer
MO PE NO. 22413

STRUCTURAL
ENGINEERING
ASSOCIATES
1000 Walnut, Suite 1570
Kansas City, Missouri 64106
www.seassociates.com
Missouri Certificate of Authority
Number: 000796
Phone: 816421-1042

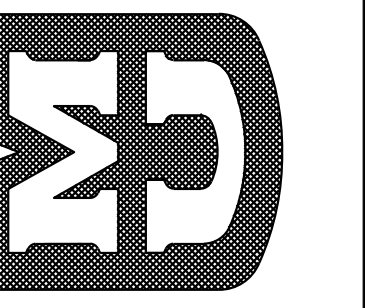

TURNER AVENUE PARKING STRUCTURE
VARIOUS STRUCTURE REPAIRS
UNIVERSITY OF MISSOURI
COLUMBIA, MISSOURI
FOR THE CURATORS OF THE UNIVERSITY OF MISSOURI

Parking Structure
Second Level Plan

DRAWN BY: LJC
CHECKED BY: RCJ
MU PROJECT NO.: CP212202
DATE: March 28, 2022
ISSUED FOR BIDS: March 28, 2022

REVISIONS:
ADD #1 04/13/2022

S107

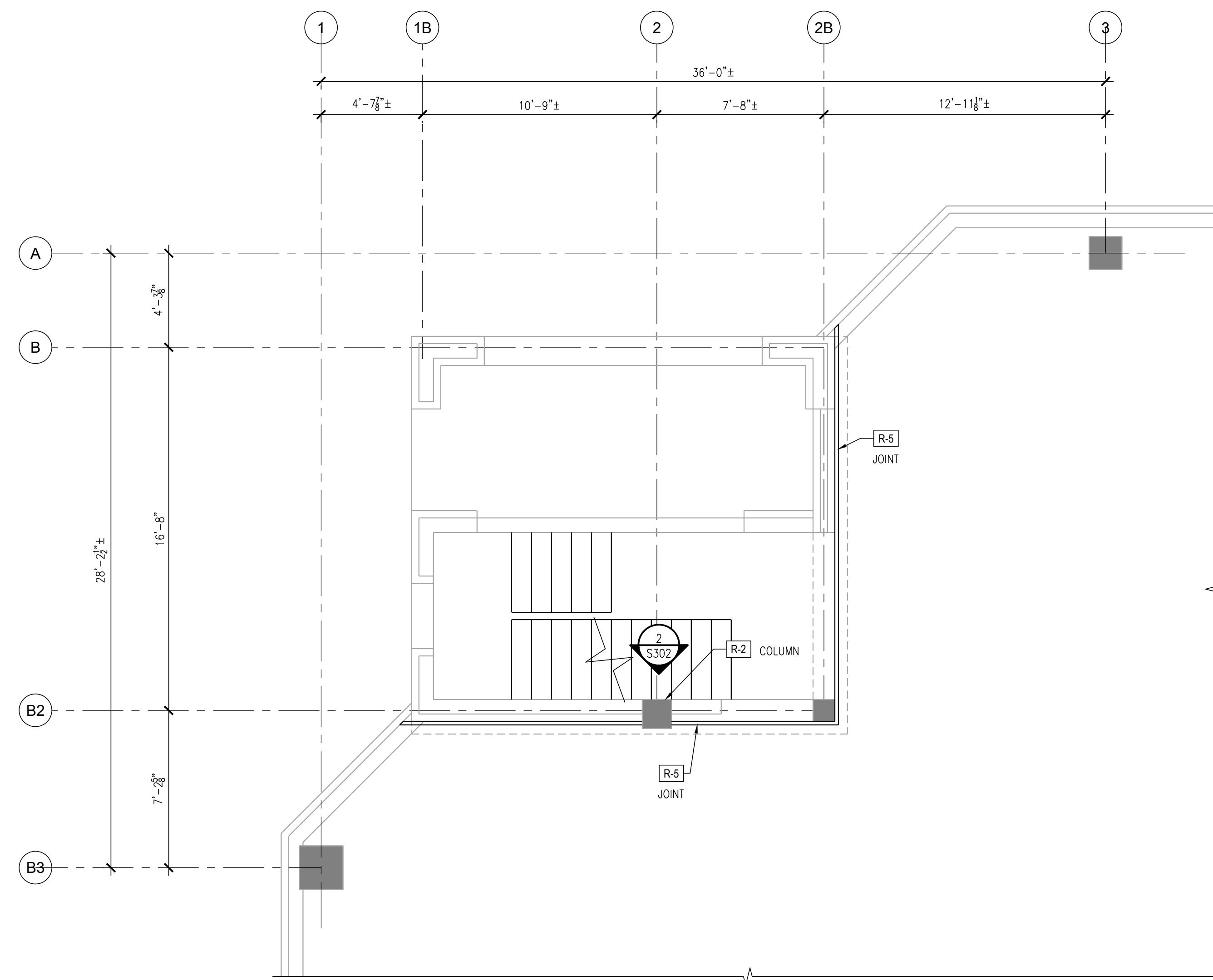

4 STAIR THIRD LEVEL
1/4" = 1'-0" N

NOTE:
CONTRACTOR TO CAPTURE ONE (1) PARKING STALL ON EACH SIDE OF STAIR TOWER AND ONE (1) ADDITIONAL STALL FOR LAY DOWN AREA OR VEHICLE INSIDE FENCED AREA DURING REPAIRS

- NOTE:
- CONTRACTOR SHALL ONLY WORK ON ONE STAIR TOWER AT A TIME
 - CONTRACTOR TO PROVIDE PEDESTRIAN BARRICADE W/ EMERGENCY EGRESS TO ALL LEVELS OF STAIR TOWER UNDER CONSTRUCTION ALONG WITH SIGNAGE INDICATING ACCESS TO STAIR TOWER IS CLOSED (REF: SPECS)
 - CONTRACTOR TO ADD A TOTAL OF TEN (10) ACCESSIBLE PARKING STALLS ON LEVEL ONE, TO BE LOCATED BY OWNERS REPRESENTATIVE. EXISTING STRIPING IN THESE LOCATIONS TO BE REMOVED BY HAND GRINDERS OR WIRE BRUSH.

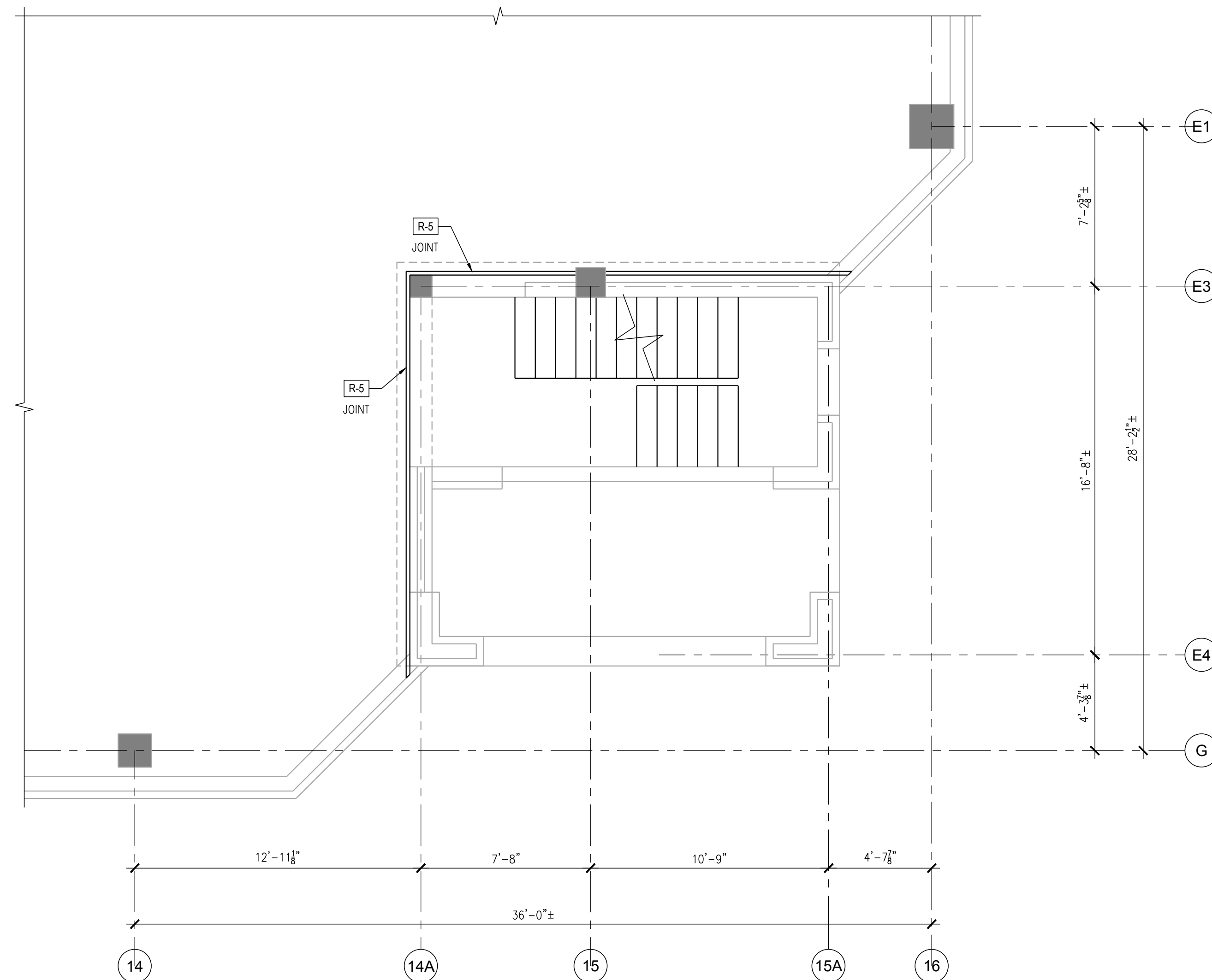

3 STAIR THIRD LEVEL
1/4" = 1'-0" N

NOTE:
CONTRACTOR TO CAPTURE ONE (1) PARKING STALL ON EACH SIDE OF STAIR TOWER AND ONE (1) ADDITIONAL STALL FOR LAY DOWN AREA OR VEHICLE INSIDE FENCED AREA DURING REPAIRS

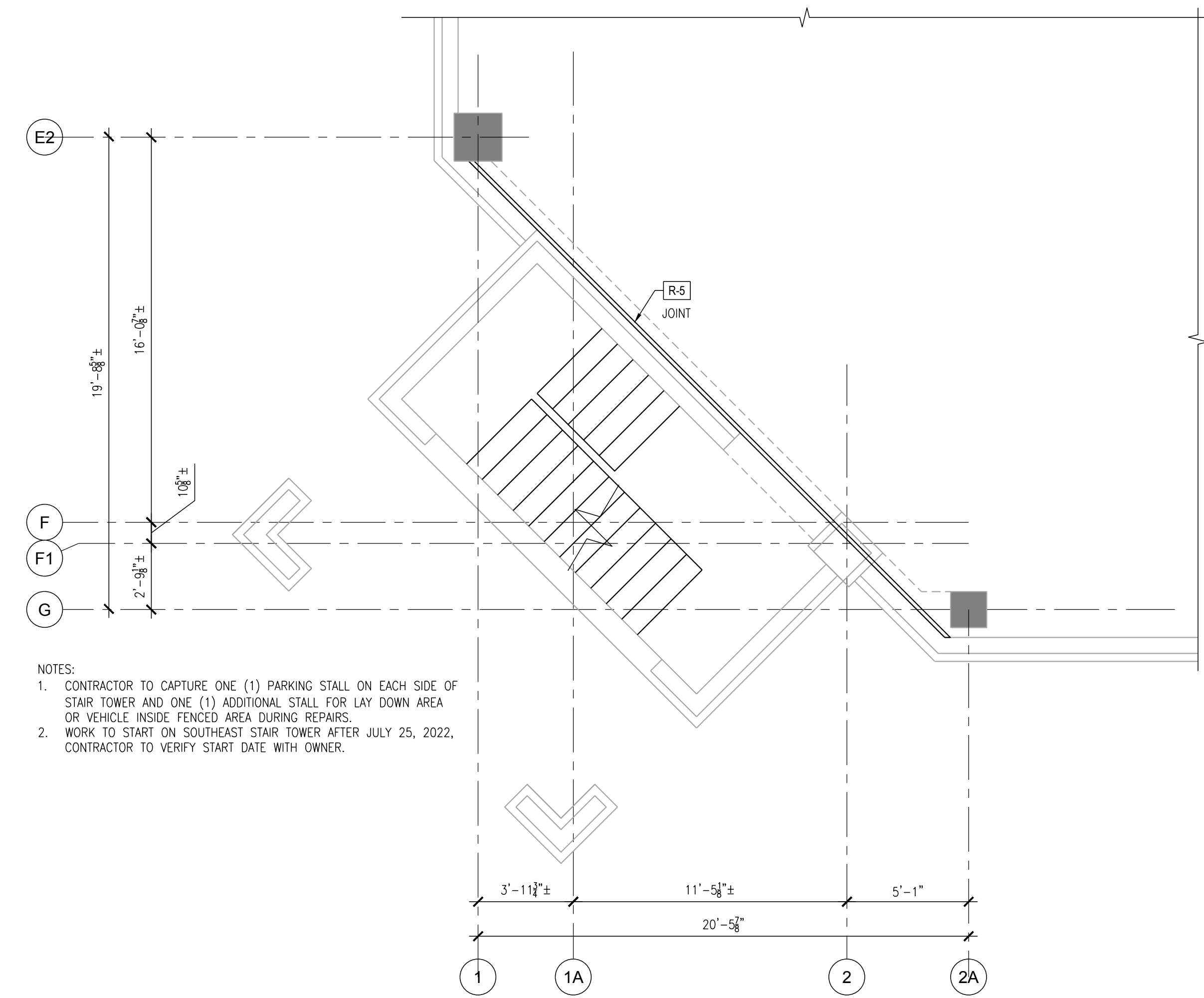

2 STAIR THIRD LEVEL
1/4" = 1'-0" N

- NOTES:
- CONTRACTOR TO CAPTURE ONE (1) PARKING STALL ON EACH SIDE OF STAIR TOWER AND ONE (1) ADDITIONAL STALL FOR LAY DOWN AREA OR VEHICLE INSIDE FENCED AREA DURING REPAIRS.
 - WORK TO START ON SOUTHEAST STAIR TOWER AFTER JULY 25, 2022, CONTRACTOR TO VERIFY START DATE WITH OWNER.

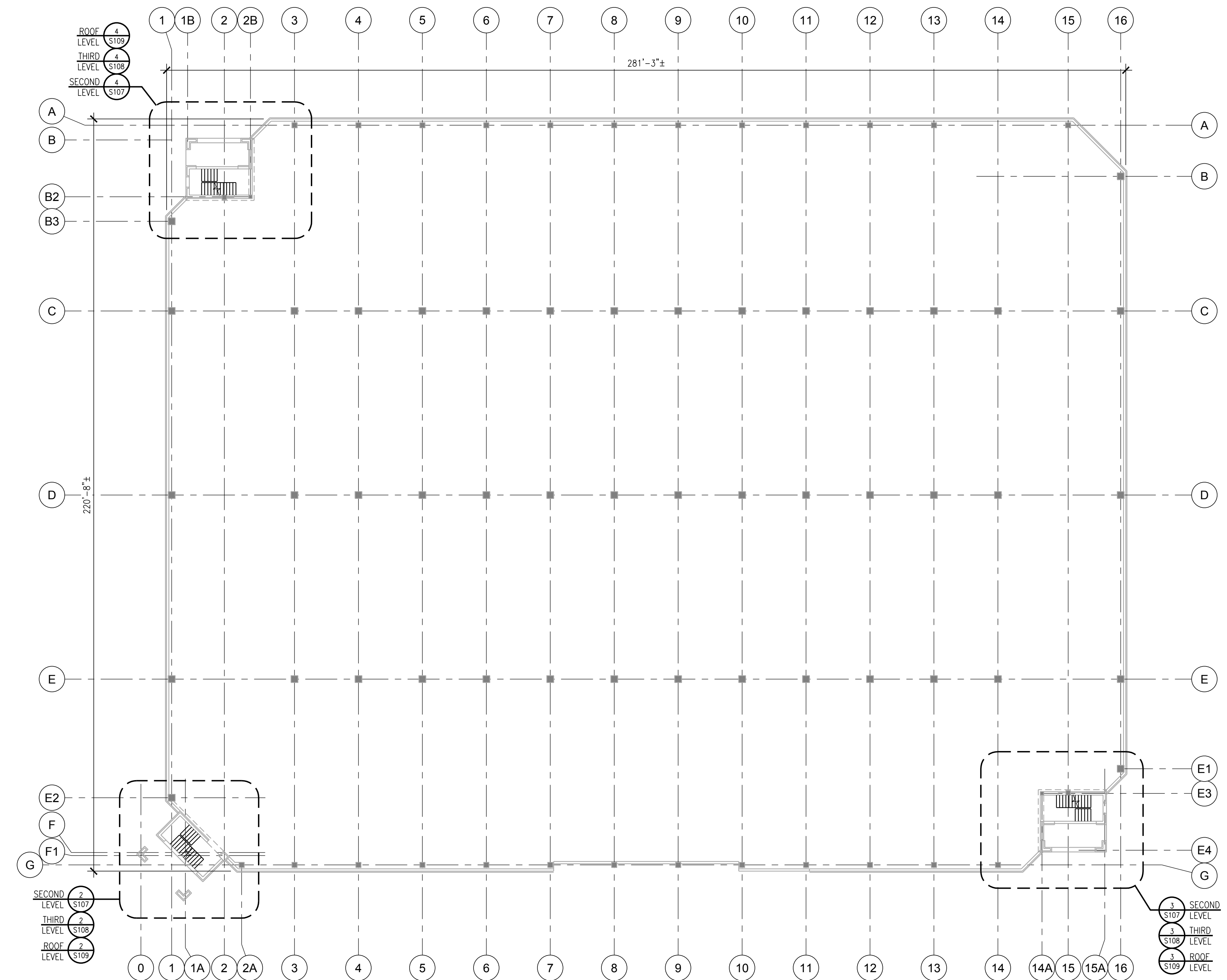

1 EXISTING CONLEY AVENUE PARKING STRUCTURE - THIRD LEVEL PLAN
3/32" = 1'-0" N

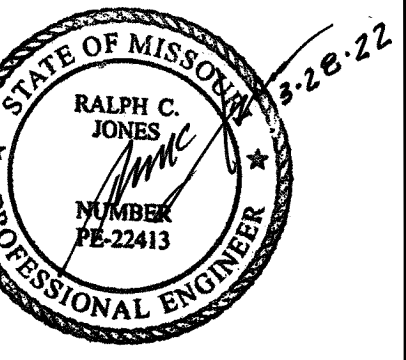

RALPH C. JONES
Professional Engineer
MO PE NO. 22413

STRUCTURAL
ENGINEERING
ASSOCIATES
1000 Walnut, Suite 1570
Kansas City, Missouri 64106
www.seassociates.com
Missouri Certificate of Authority
Number: 000796

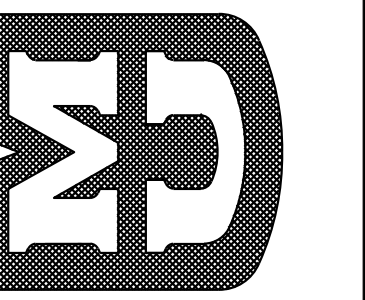

TURNER AVENUE PARKING STRUCTURE
VARIOUS STRUCTURE REPAIRS
UNIVERSITY OF MISSOURI
COLUMBIA, MISSOURI
FOR THE CURATORS OF THE UNIVERSITY OF MISSOURI

Parking Structure
Third Level Plan

DRAWN BY
LGC
CHECKED BY
RCJ
MU PROJECT NO.
CP212202
DATE
ISSUED FOR BIDS
March 28, 2022

REVISIONS:

ADD #1 04/13/2022

S108

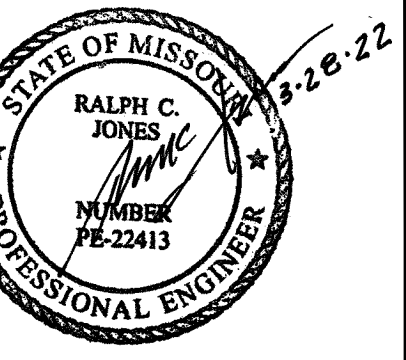

RALPH C. JONES
Professional Engineer
MO PE NO. 22413

STRUCTURAL
ENGINEERING
ASSOCIATES
1000 Walnut, Suite 1570
Kansas City, Missouri 64106
www.seassociates.com
Missouri Certificate of Authority
Number: 000796
Phone: 816421-1042

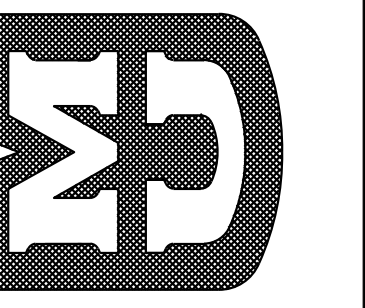

TURNER AVENUE PARKING STRUCTURE
VARIOUS STRUCTURE REPAIRS
UNIVERSITY OF MISSOURI
COLUMBIA, MISSOURI
FOR THE CURATORS OF THE UNIVERSITY OF MISSOURI

Parking Structure Roof
Level Plan

DRAWN BY
LGC
CHECKED BY
RCJ
MU PROJECT NO.
CP212202
DATE
ISSUED FOR BIDS
March 28, 2022

REVISIONS:

ADD #1 04/13/2022

S109

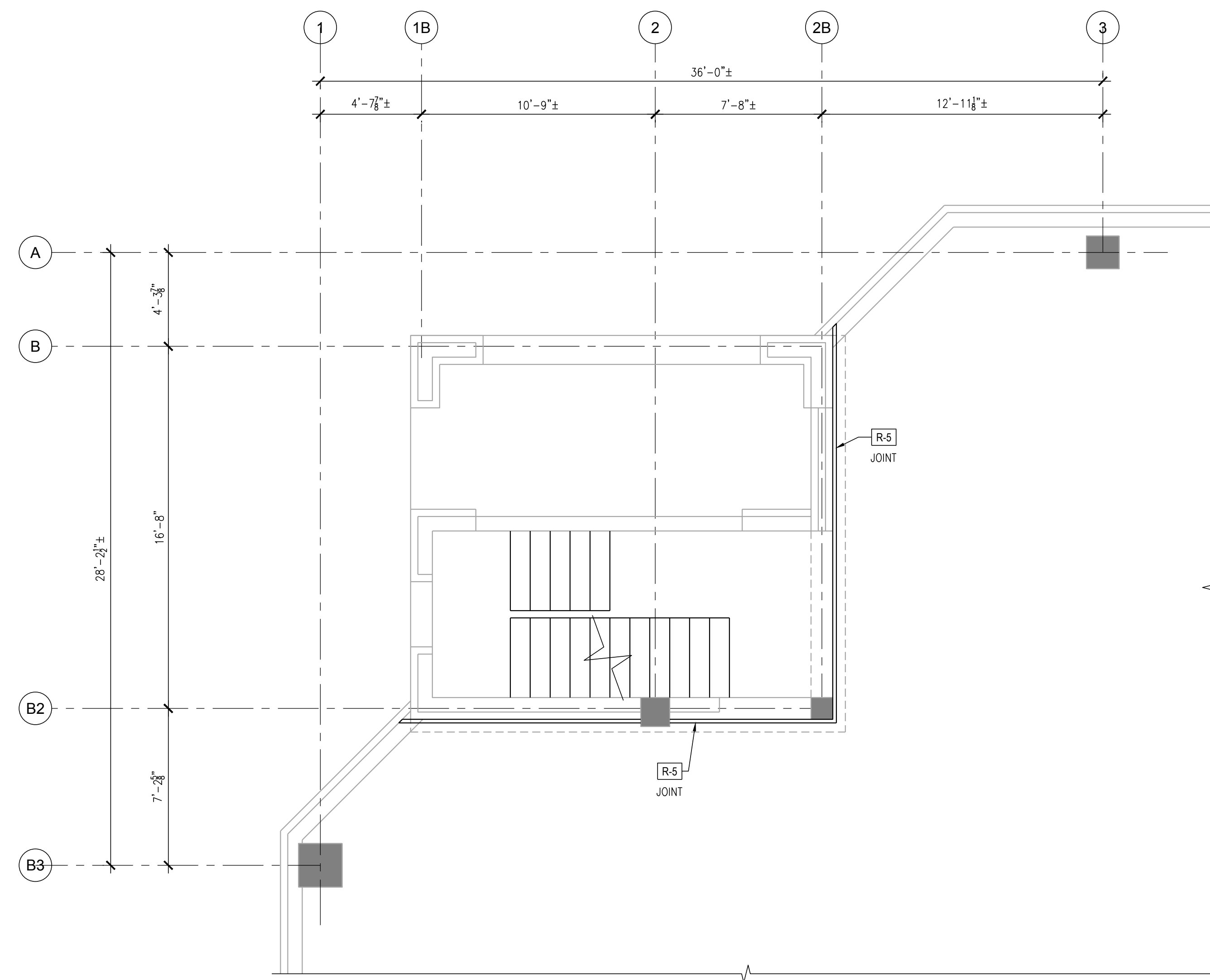

4 STAIR ROOF LEVEL
1/4" = 1'-0" N

NOTE:
CONTRACTOR TO CAPTURE ONE (1) PARKING STALL ON EACH SIDE
OF STAIR TOWER AND ONE (1) ADDITIONAL STALL FOR LAY DOWN
AREA OR VEHICLE INSIDE FENCED AREA DURING REPAIRS

- NOTE:
1. CONTRACTOR SHALL ONLY WORK ON ONE STAIR TOWER AT A TIME
 2. CONTRACTOR TO PROVIDE PEDESTRIAN BARRICADE W/ EMERGENCY EGRESS TO ALL LEVELS OF STAIR TOWER UNDER CONSTRUCTION ALONG WITH SIGNAGE INDICATING ACCESS TO STAIR TOWER IS CLOSED (REF: SPECS)
 3. CONTRACTOR TO ADD A TOTAL OF TEN (10) ACCESSIBLE PARKING STALLS ON LEVEL ONE, TO BE LOCATED BY OWNERS REPRESENTATIVE. EXISTING STRIPING IN THESE LOCATIONS TO BE REMOVED BY HAND GRINDERS OR WIRE BRUSH.

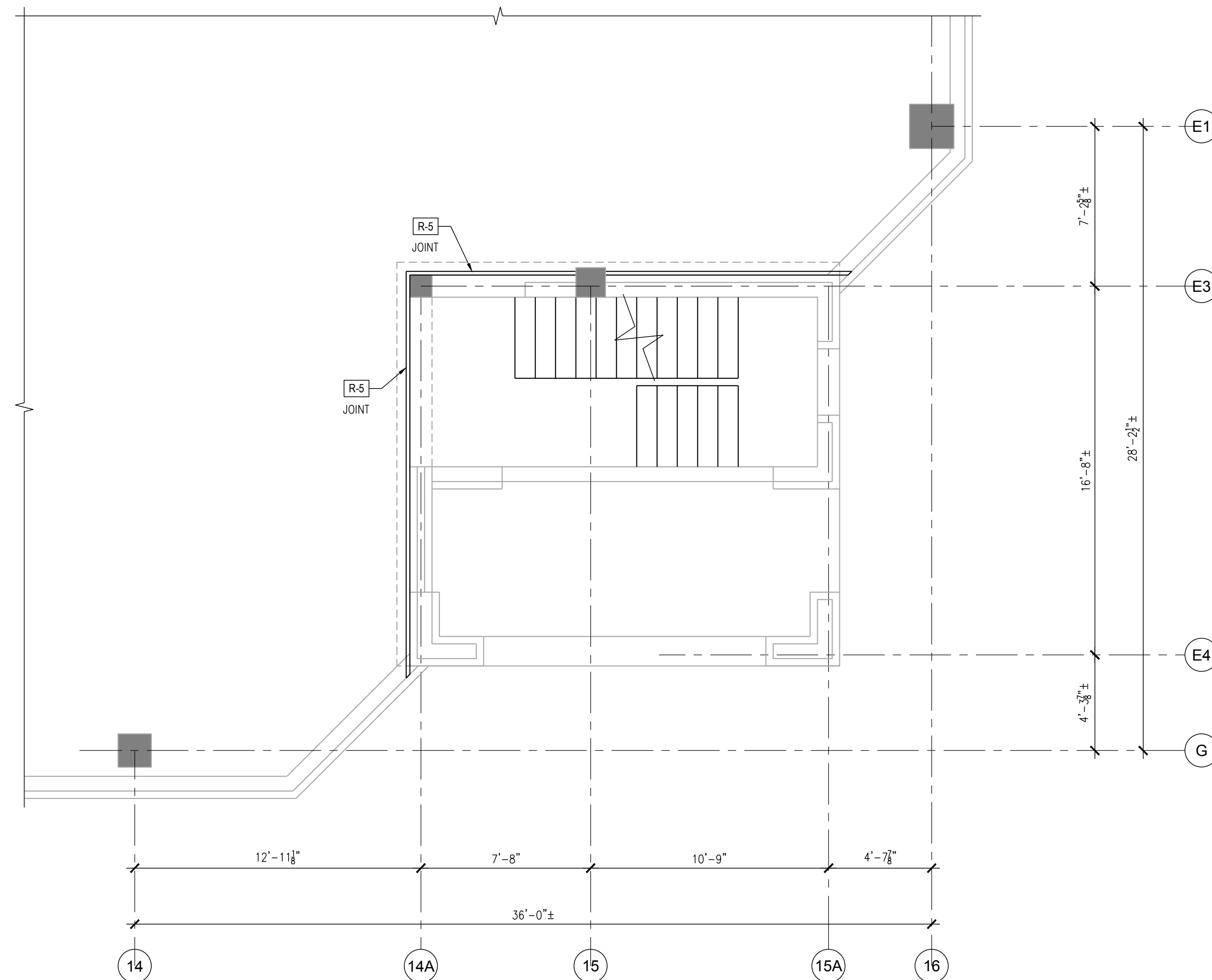

3 STAIR ROOF LEVEL
1/4" = 1'-0" N

NOTE:
CONTRACTOR TO CAPTURE ONE (1) PARKING STALL ON EACH SIDE
OF STAIR TOWER AND ONE (1) ADDITIONAL STALL FOR LAY DOWN
AREA OR VEHICLE INSIDE FENCED AREA DURING REPAIRS

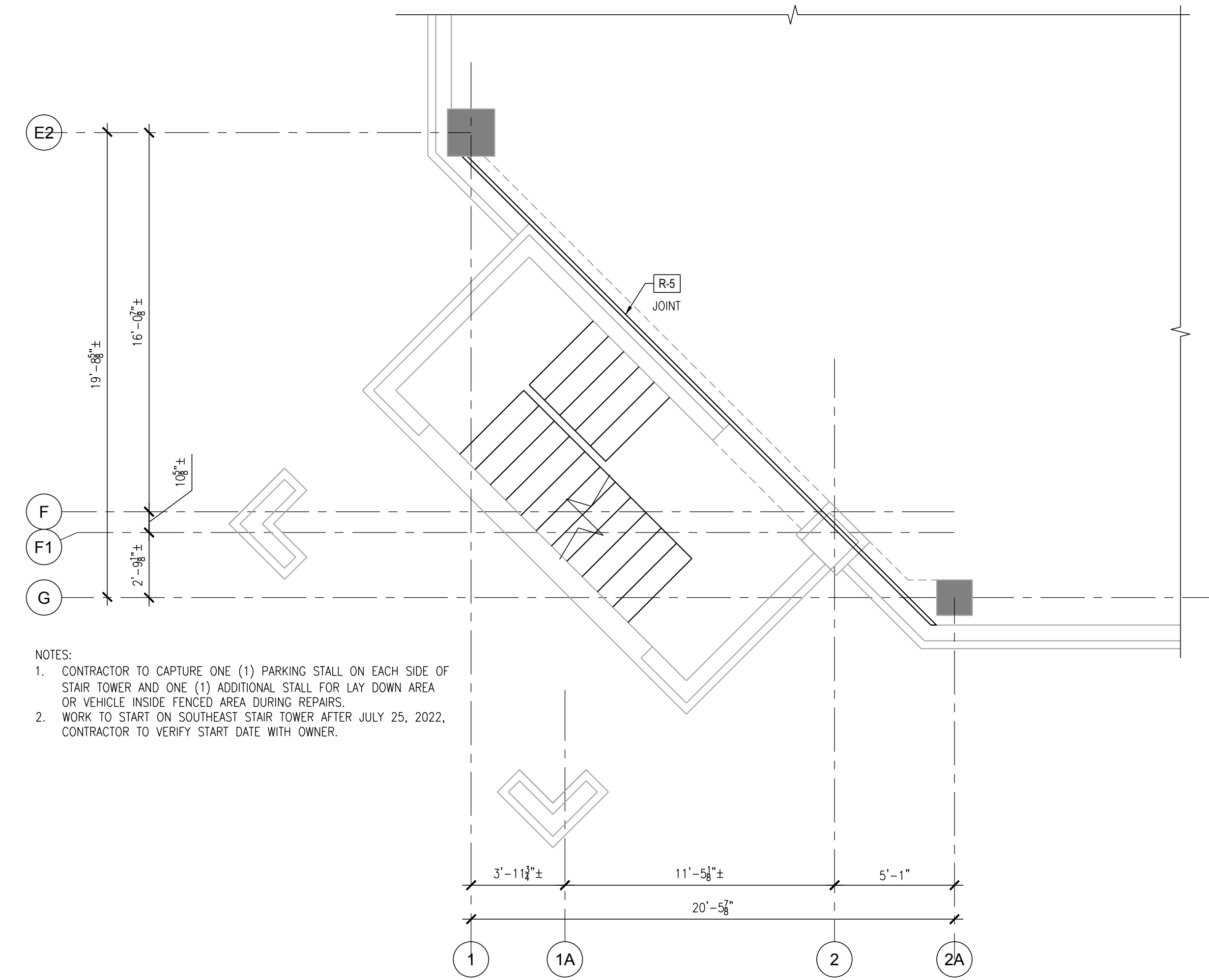

2 STAIR ROOF LEVEL
1/4" = 1'-0" N

- NOTES:
1. CONTRACTOR TO CAPTURE ONE (1) PARKING STALL ON EACH SIDE OF STAIR TOWER AND ONE (1) ADDITIONAL STALL FOR LAY DOWN AREA OR VEHICLE INSIDE FENCED AREA DURING REPAIRS.
 2. WORK TO START ON SOUTHEAST STAIR TOWER AFTER JULY 25, 2022, CONTRACTOR TO VERIFY START DATE WITH OWNER.

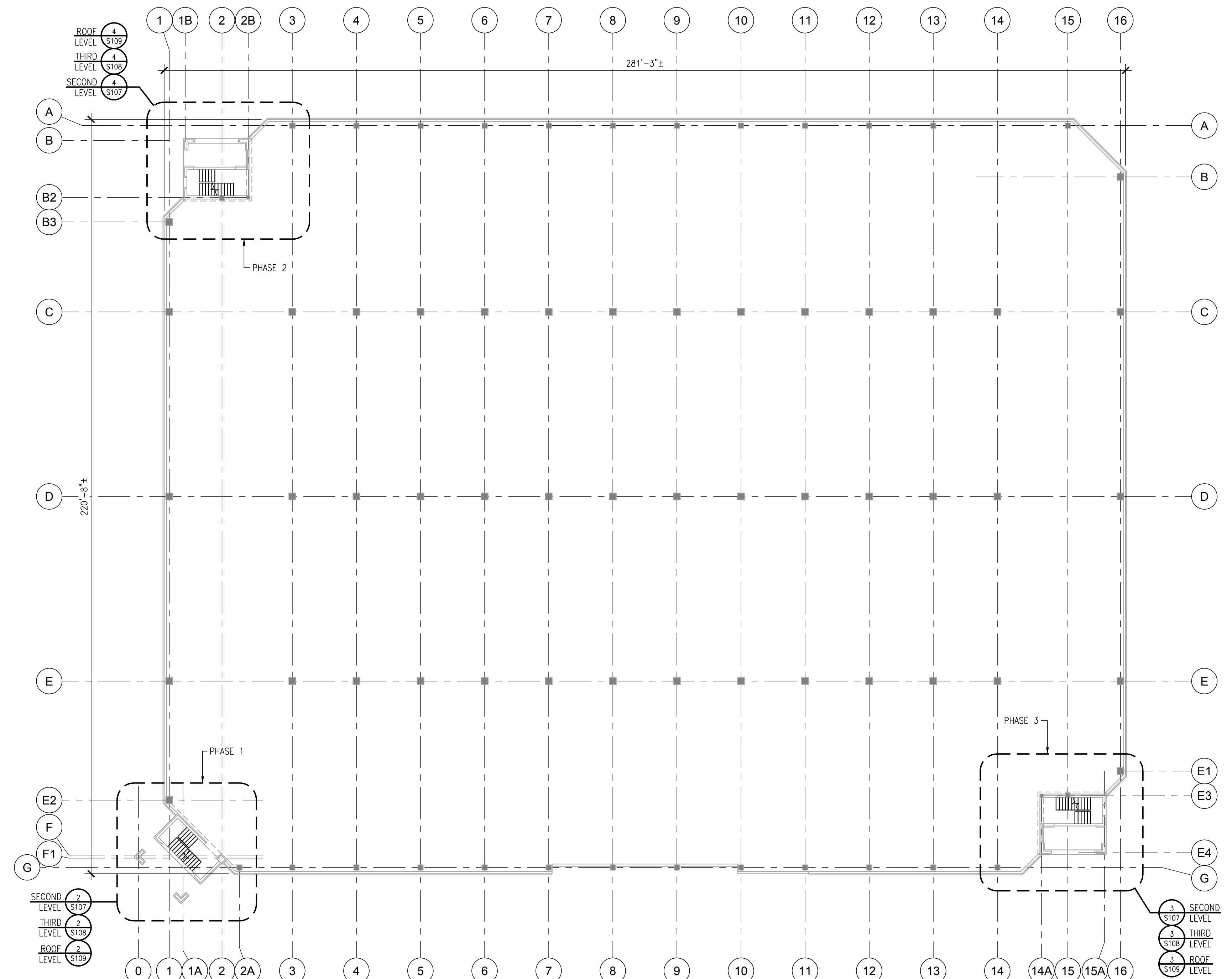

1 EXISTING CONLEY AVENUE PARKING STRUCTURE - ROOF LEVEL PLAN
3/32" = 1'-0" N